

Bridle Rings with Machine Screw Thread



Material/Finish:

Steel, zinc plating

Application:

These machine-screw thread bridle rings are use to support communications cables and other low voltage wires.

Advantages:

Bridle rings allow a quick and inexpensive way to support non-sensitive wires and cables from structural members. These bridle rings may be used with any 10-24 or 1/4-20 threaded clamps or supports.

Catalog Number	Size(ΦA)	Thread(B)	C	Loading Capacity	Std. Pkg.
ZQBR125	1-1/4"	1/4-20	25.4[1.00]	50LBS	100
ZQBR150	1-1/2"	1/4-20	25.4[1.00]	50LBS	100
ZQBR200	2"	1/4-20	25.4[1.00]	50LBS	100
ZQBR400	4"	1/4-20	25.4[1.00]	50LBS	100
ZQBR501024	1/2"	10-24	15.0[0.59]	50LBS	100
ZQBR751024	3/4"	10-24	15.0[0.59]	50LBS	100
ZQBR1001024	1"	10-24	15.0[0.59]	50LBS	100
ZQBR1251024	1-1/4"	10-24	15.0[0.59]	50LBS	100
ZQBR1501024	1-1/2"	10-24	27.0[1.06]	50LBS	100
ZQBR2001024	2"	10-24	15.0[0.59]	50LBS	100

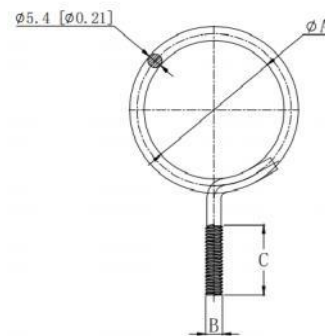

All dimensions in mm[inch]